



Hazeldene, Crockford Park Road, Addlestone, KT15 2LD





Offered to the market is this spacious first-floor apartment, featuring two generous double bedrooms and located in a peaceful cul-de-sac off one of Addlestone's most sought-after roads.

Beautifully presented throughout to a high standard, the accommodation comprises a bright and airy lounge/dining area, a separate fitted kitchen, a contemporary three-piece family bathroom, and two well-proportioned double bedrooms, the principle of which has built-in wardrobes,

Additional benefits include a single garage located in a nearby block, well-maintained communal gardens, and residents' parking.

Leasehold - Share of Freehold



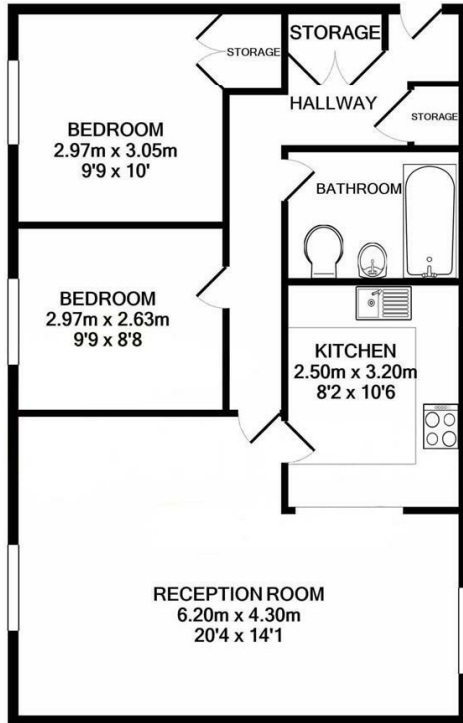

**TOTAL APPROX. FLOOR AREA 62.8 SQ.M. (676 SQ.FT.)**

Whilst every attempt has been made to ensure the accuracy of the floor plan contained here, measurements of doors, windows, rooms and any other items are approximate and no responsibility is taken for any error, omission, or mis-statement. This plan is for illustrative purposes only and should be used as such by any prospective purchaser. The services, systems and appliances shown have not been tested and no guarantee as to their operability or efficiency can be given

Made with Metropix ©2020



**EPC Rating: 39 E**

**g**  
**GRANTS**  
**HOMES**





Grants Homes 155 Station Road, Addlestone, Surrey, KT15 2AT  
T: 01932 858885 E: [addlestone@grantshomes.co.uk](mailto:addlestone@grantshomes.co.uk)

